

# St. Augustine

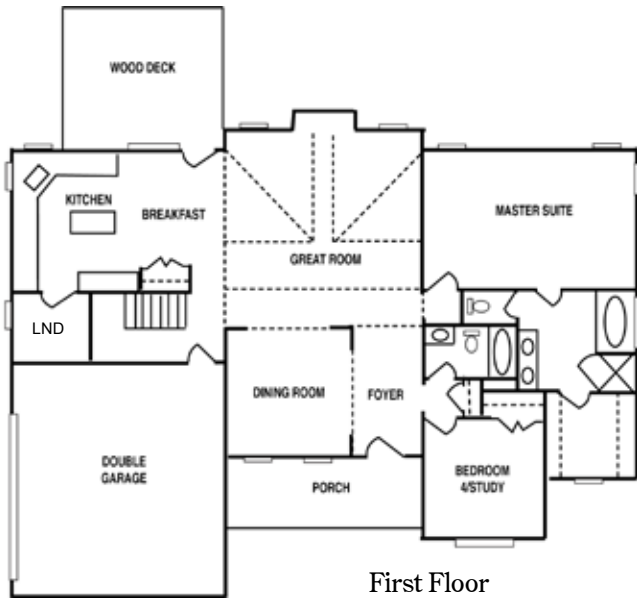

*Welcome to the Family*



First Floor

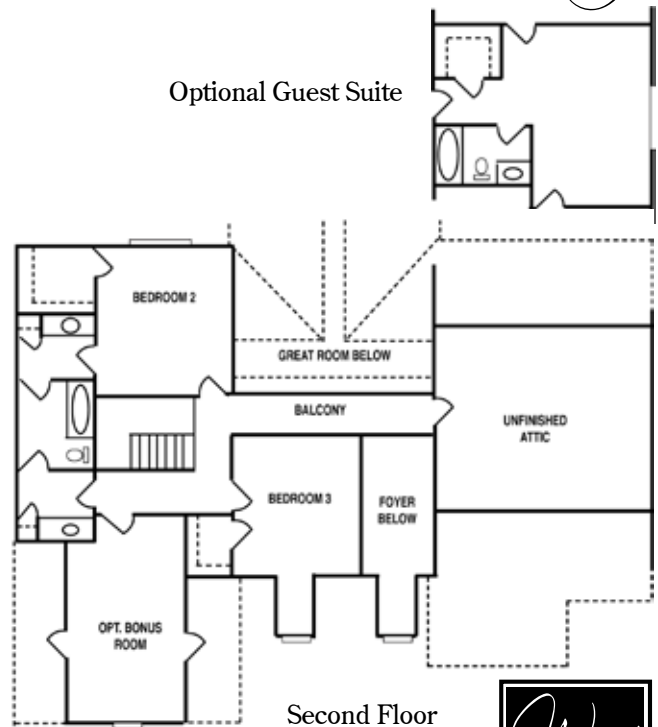

Second Floor

**4 Beds + Bonus, 3 Baths**

1st Floor	1872 sq. ft.
2nd Floor	1396 sq. ft.
<b>Total</b>	<b>3268 sq. ft.</b>

For additional information, please visit [www.wynsorhomes.com](http://www.wynsorhomes.com).



*A modified House Plan Services plan. All plans, specifications and pricing are estimates and subject to change. Drawings are shown with some available options and upgrades. Square footage based on a full brick home and may vary if less than full brick. Interior measurements remain the same.*



**WYNSOR  
HOMES**